

Product Features

Accurate Mileage Counter	Based on wheel diameter and RPM Diameter adjustable
Localisation in Real-Time Via Web Service	Current vehicle position including driving direction Track history Actual mileage Movement detection to provide actual position after shunting Typical update interval: 15 minutes when moving / every 12 hours at standstill Geo fencing
Integrated Power Supply	Self-sustaining system with integrated generator Buffer battery for operation at standstill
Easy Installation	Replaces original bearing cap No external cables Typical installation time 15 minutes
Maintenance Free System	Automatic data upload to WaggonTracker Service Maintenance of buffer battery in line with vehicle service interval
WaggonTracker Service	Software as a Service – Infrastructure hosted by PJM WaggonTracker web portal Integration in existing customer system via REST API possible (fair use policy)



Technical Specifications

TSI 321/2013 Compliance	Gauging Axle bearing condition monitoring
Body Colour	In line with VPI 04-3 maintenance guideline
GPS Module	ublox LEA-6 Usual GPS Accuracy: 2,5m (autonomous, CEP, 50%, 24h static)
GSM Module	ublox LEON G200 Quad-band GSM/GPRS modem
Generator	Non-contact wheel hub generator Output >10W
Buffer Battery	LiFePo4, 2 cells in series, 2500mAh Operating time on battery: 3-4 weeks when fully charged Required vehicle speed for charging via generator: >15km/h (wheel diameter 920mm) Typically 6 years maintenance cycle
Operating Temperature	-20°C to 55°C



WaggonTracker STD-3L

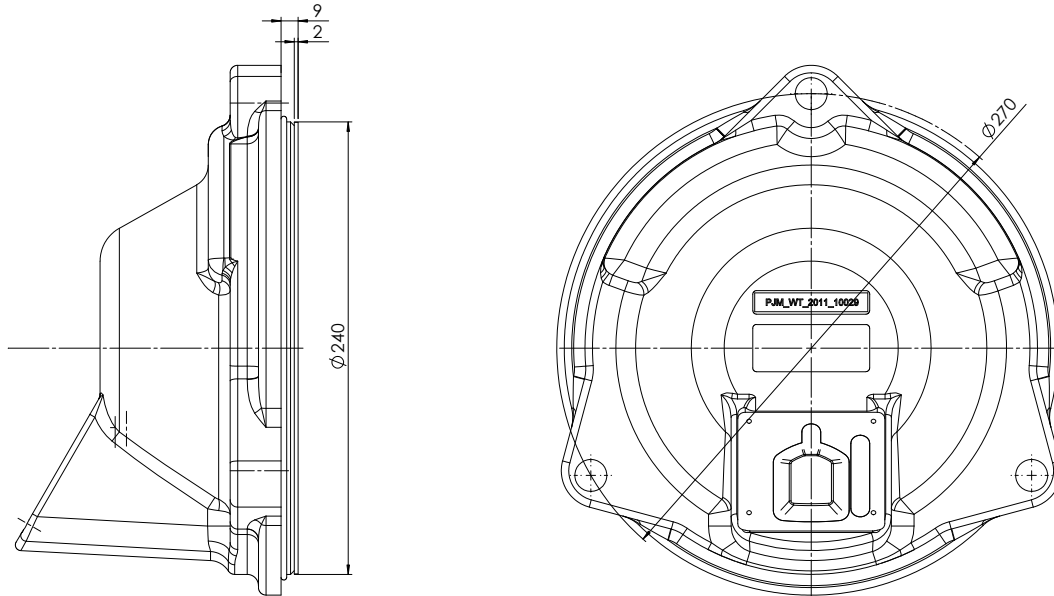

WaggonTracker STD-4L-a (34,5) / STD-4L-b (31,5)

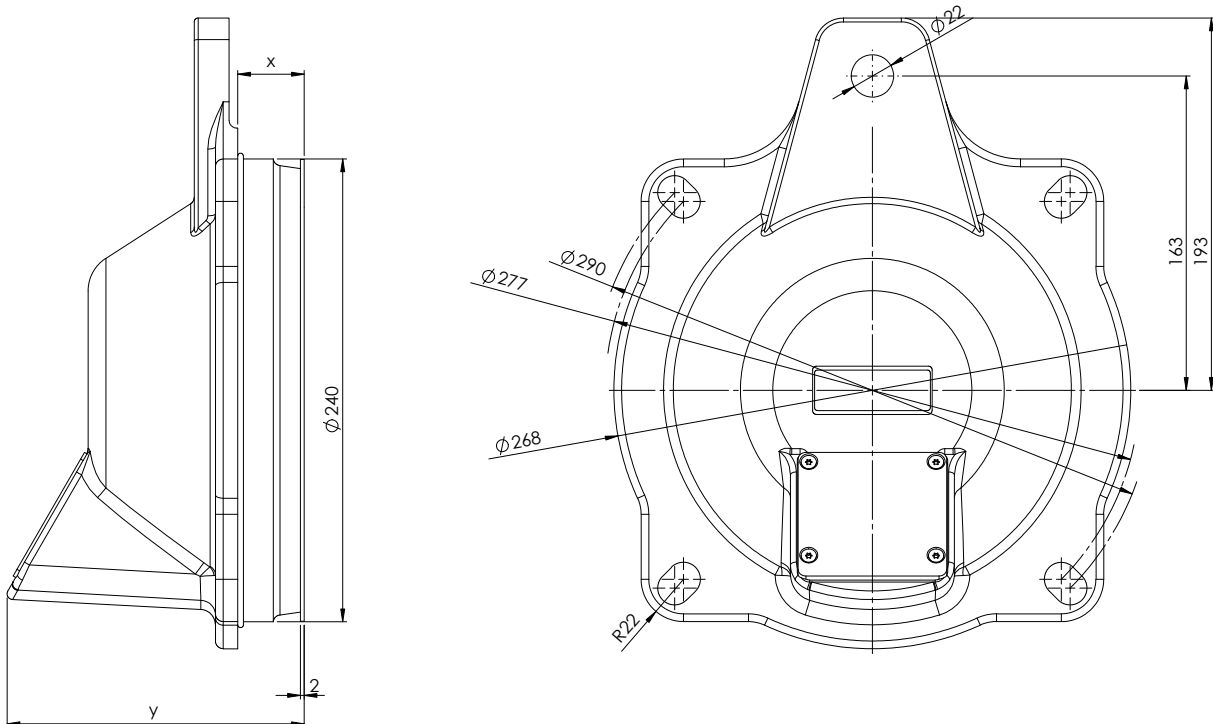

STD-4L-a: x=34,5mm, y=154mm

STD-4L-b: x=31,5mm, y=151mm